

PARTS LIST						
ITEM	QTY	PART NO.	PART DESCRIPTION	LENGTH	UNIT WT.	NET WT.
1	1	X-CSRT-3024FW	CSRT FLANGE PIPE WELDMENT 2-7/8" x 24"		14.54	14.54
2	4	G1202	1/2" x 2" HDG HEX BOLT GR5	2 in	0.18	0.70
3	4	G12LW	1/2" HDG LOCKWASHER	1/8 in	0.01	0.06
4	4	G12NUT	1/2" HDG HEAVY 2H HEX NUT	7/8 in	0.07	0.29
					TOTAL WT. #	15.58

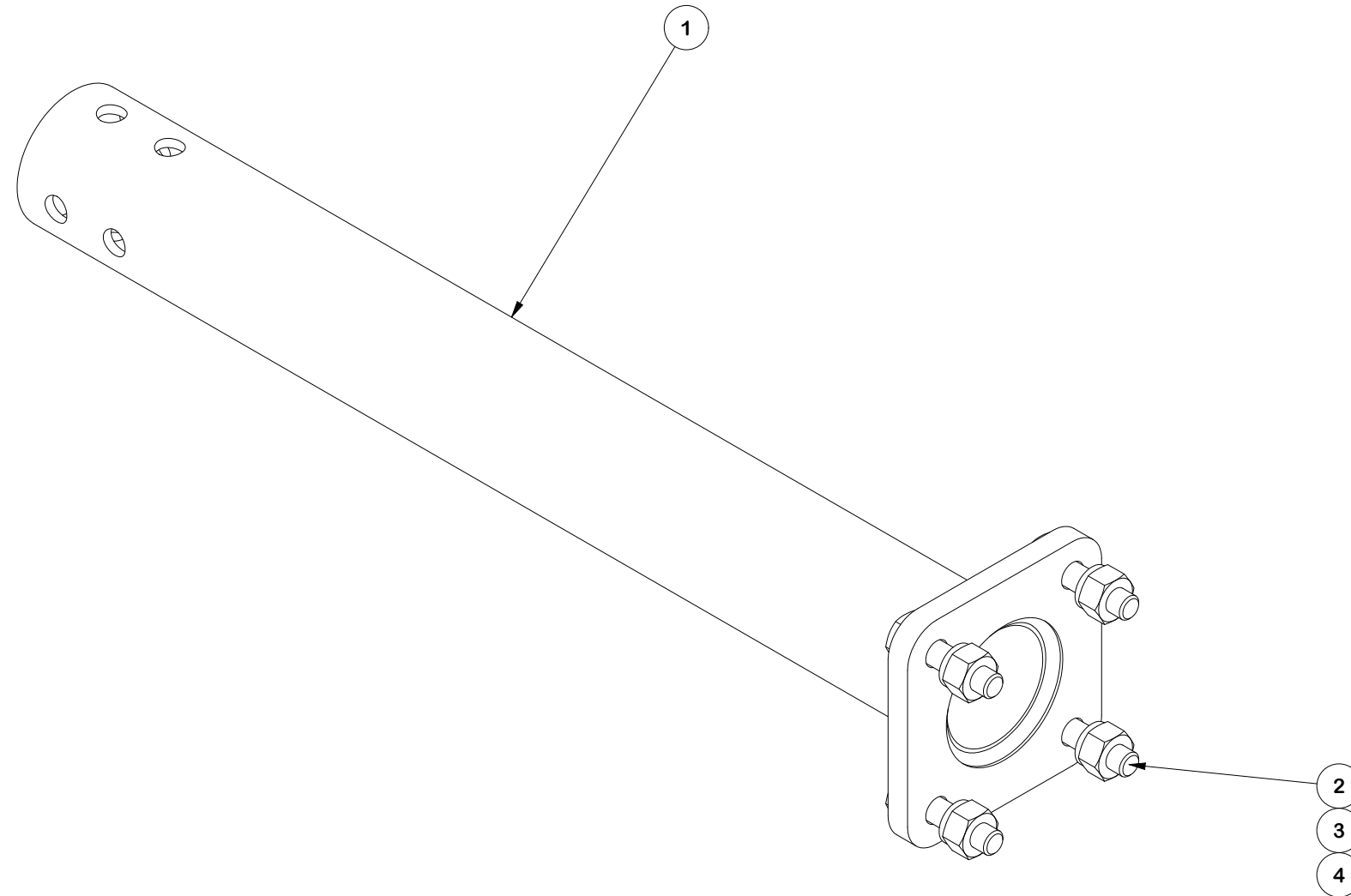

**FINISH:**  
HOT DIP GALVANIZED.

**TOLERANCE NOTES**

TOLERANCES ON DIMENSIONS, UNLESS OTHERWISE NOTED ARE:  
 SAWED, SHEARED AND GAS CUT EDGES ( $\pm 0.030"$ )  
 DRILLED AND GAS CUT HOLES ( $\pm 0.030"$ ) - NO CONING OF HOLES  
 LASER CUT EDGES AND HOLES ( $\pm 0.010"$ ) - NO CONING OF HOLES  
 BENDS AND ANGLES ARE  $\pm 1/2$  DEGREE  
 ALL OTHER MACHINING ( $\pm 0.030"$ )  
 ALL OTHER ASSEMBLY ( $\pm 0.060"$ )

PATENT INFORMATION: WWW.SITEPRO1.COM/PATENTS

PROPRIETARY NOTE:  
 THE DATA AND TECHNIQUES CONTAINED IN THIS DRAWING ARE PROPRIETARY INFORMATION OF VALMONT INDUSTRIES AND CONSIDERED A TRADE SECRET. ANY USE OR DISCLOSURE WITHOUT THE CONSENT OF VALMONT INDUSTRIES IS STRICTLY PROHIBITED.

DESCRIPTION  
**CSRT FLANGE PIPE WELDMENT  
 2-7/8" X 48" W / HARDWARE**

CPD NO. <b>NCS</b>	DRAWN BY <b>SDR 12/4/2025</b>	ENG. APPROVAL <b>12/18/2025</b>
CLASS <b>87</b>	SUB <b>02</b>	DRAWING USAGE <b>CUSTOMER</b>
CHECKED BY <b>JET 12/18/2025</b>		

**SITE PRO 1**  
 A valmont COMPANY

Engineering Support Team:  
 sp1engineering@valmont.com

PART NO. <b>CSRT-3024FW</b>	PAGE 1 OF 1
DWG. NO. <b>CSRT-3024FW</b>	